

THE CORPORATION OF THE
TOWNSHIP OF BONNECHERE VALLEY

BY-LAW 2008-102

**A BY-LAW TO AMEND COMPREHENSIVE ZONING
BY-LAW NUMBER 2006-28 OF THE TOWNSHIP OF BONNECHERE VALLEY**

PURSUANT TO SECTIONS 34 OF THE PLANNING ACT, R.S.O. 1990, c.P. 13,
THE CORPORATION OF THE TOWNSHIP OF BONNECHERE VALLEY
HEREBY ENACTS AS FOLLOWS:

1. THAT Comprehensive Zoning By-Law Number 2006-28 is hereby amended as follows:
 - (a) By adding a new subsection immediately following Section 24.3 (hh) as follows:

“24.3 (ii) Rural-Exception Thirty-Six (RU-E36)

 - a) Notwithstanding any other provision of this By-law to the contrary, for the lands zoned Rural-Exception Thirty-Six(RU-36) and located within Lot 6, Concession 6, in the geographic Township of South Algona, the minimum lot size shall be 1.6 hectares (3.9 acres).
- (b) Schedule “A-1” to By-Law Number 2006-28, as amended, of the Township of Bonnechere Valley, is further amended by rezoning lands located within Lot 6, Concession 6 in the geographic township of South Algona from “Rural (RU)” and Rural Residential (RR) to “Rural-Exception Thirty-Six” (RU-36), as shown as Item 1 on Schedule “A” attached hereto and forming part of this By-law.
2. THAT save as aforesaid all other provisions of By-Law Number 2006-28 as amended shall be complied with.
3. THIS By-law shall come into force and take effect on the day of final passing thereof.

THIS BY-LAW GIVEN ITS FIRST AND SECOND READING THIS 16TH DAY OF
DECEMBER 2008.

THIS BY-LAW GIVEN ITS THIRD TIME AND FINALLY PASSED THIS 16TH DAY
OF DECEMBER, 2008.

MAYOR

CORPORATE
SEAL OF
MUNICIPALITY

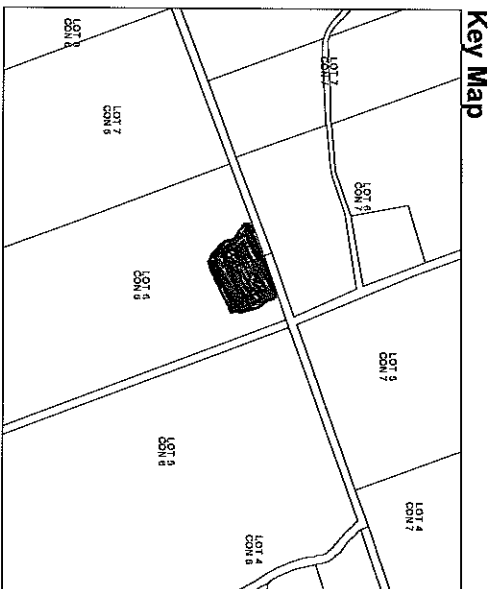

C.A.O.

**Geographic Township of South Algona
in the Township of Bonnechere Valley**



Key Map

Area Affected by
Zoning Amendment
To Rural Exception 36



THE CORPORATION OF THE TOWNSHIP OF BONNECHERE VALLEY

THIS IS SCHEDULE "A" TO BY-LAW 2008-102
Passed this 16th day of December 2008

Signature of Officers

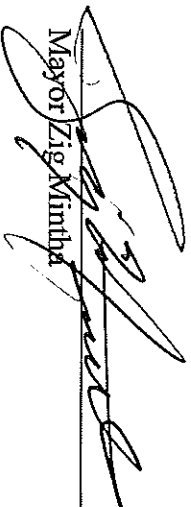

Mayor Zig Mintha

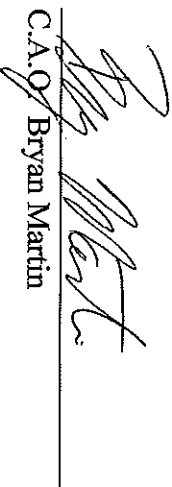

C.A.O. Bryan Martin

Area affected by amendment

